



DISC BRUSH

At Sacema we manufacture a wide range of disc brushes, both with straight and angled outlet, as the applications are very diverse. You can choose all the specifications in terms of dimensions and brush materials. As for the fibre material, we work with a wide variety of materials, such as synthetic fibres, natural fibres, metal wire...

Measures to be defined

- Outside diameter: D_{ext}
- Inside Diameter: D_{int}
- Overall diameter: D_{global}
- Shaft diameter
- Number of rows
- Diameter of the strands
- Spacing between strands
- Angle of inclination: C°

Fibres to be defined

- Synthetic
- Natural: vegetable or animal
- Metal wires
- Wood, plastic or metal base

See the
update
of the Disc Brush



Type

Disc

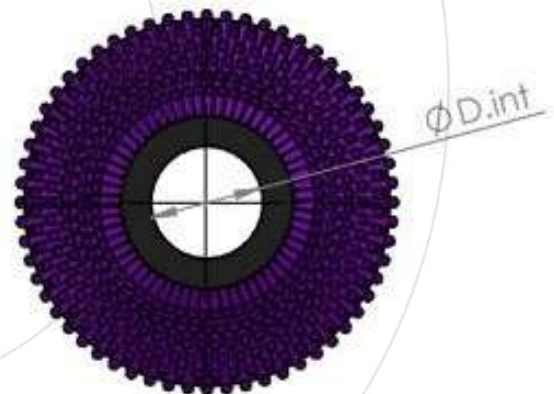

Sacema

Last updated: 27 April 2021

*These documents are the exclusive property of Cepillos Sacema, S.L. Total or partial reproduction without our written authorisation is prohibited, as is misuse and/or exposure to third parties. We reserve the right to make errors and technical modifications.

Sacema

Contacto: www.sacemagroup.com
+34 984 06 80 80 - info@sacema.es



DISC BRUSH

Disc Sectors

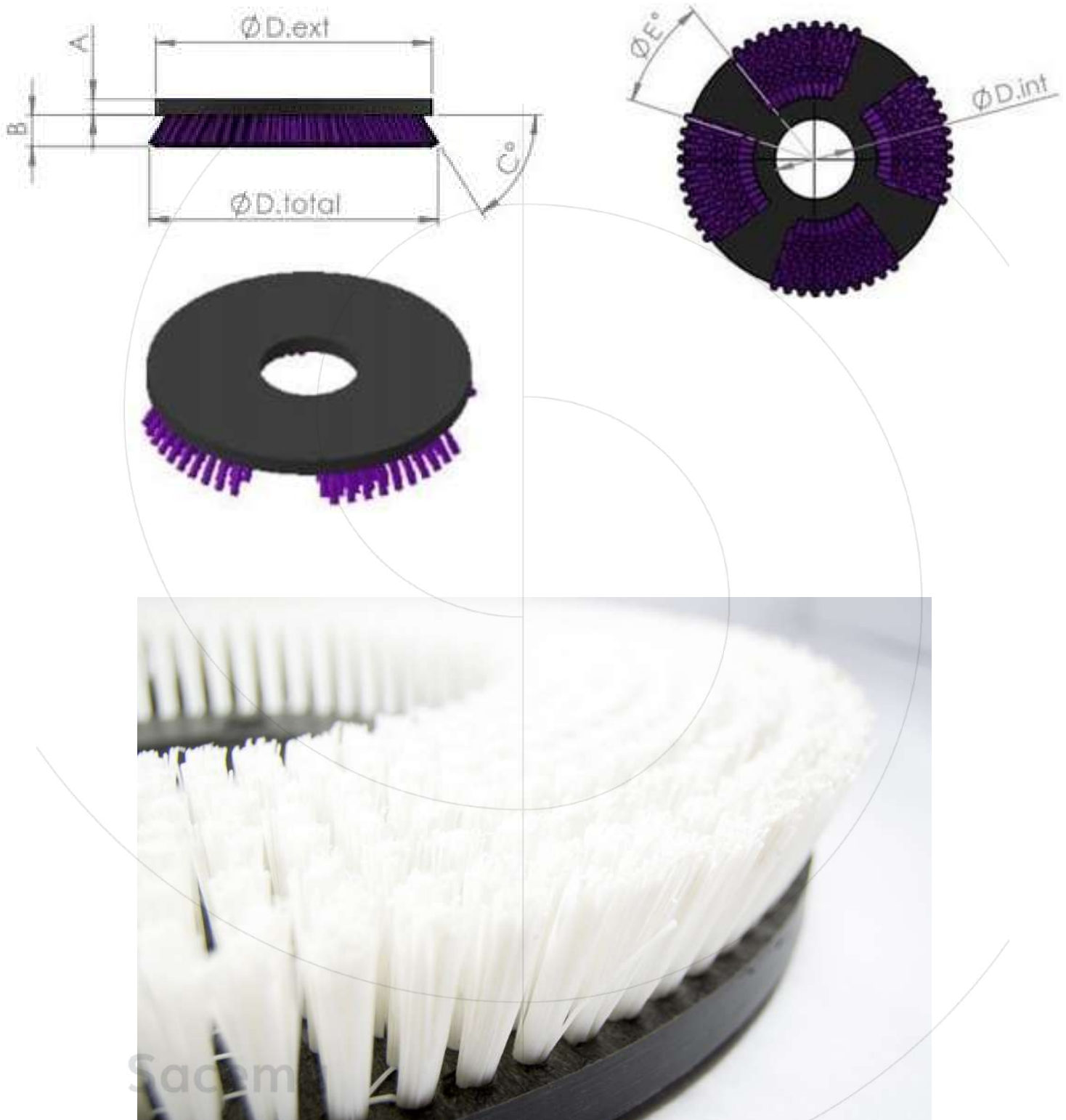

Last updated: 27 April 2021

*These documents are the exclusive property of Cepillos Sacema, S.L. Total or partial reproduction without our written authorisation is prohibited, as is misuse and/or exposure to third parties. We reserve the right to make errors and technical modifications.