

# SPECIAL METAL BRUSHES

## VULCANIZED

Circular F-26 for portable electric or pneumatic machines

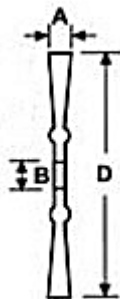

Exterior (D)	Largura (A)	Eixo de rosca (B)	R.P. M Recom.	R.P.M. Máx. de seguridade	Unid. caixa
175 / 7"	6 / 1/4"	22 / 7/8" M-14 W-5/8MR	22000	60000	12

Vessel F-26 for electric or pneumatic portable machines

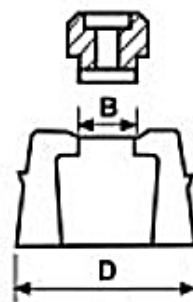

Exterior (D)	Eixo de rosca (B)	R.P. M Recom.	R.P.M. Máx. de seguridade	Unid. caixa
75 / 3"	M-14 W-5/8 MR	11000	13000	12 (blister)



GOGOR vulcanized

Tipo	Exterior (D)	Unid. caixa
Circular	65 / 2.3/4"	12 (blister)
Taça	50 / 2"	
Brocha	22 / 7/8"	



# HIGH REVOLUTIONS LINES

## Wavy Wire



Modelo	Exterior (D)	Saliente (S)	Eixo de rosca (B)	R.P. M Recom.	R.P.M. Máx. de segurança	Unid. caixa
Vaso	75 / 3"	22 / 7/8"	M-14 W-5/8 MR	11000	13000	12
Cônico	100 / 4"	24 / 1"				
Plano	115 / 4.1/2"	25 / 1"				

## Braided wire

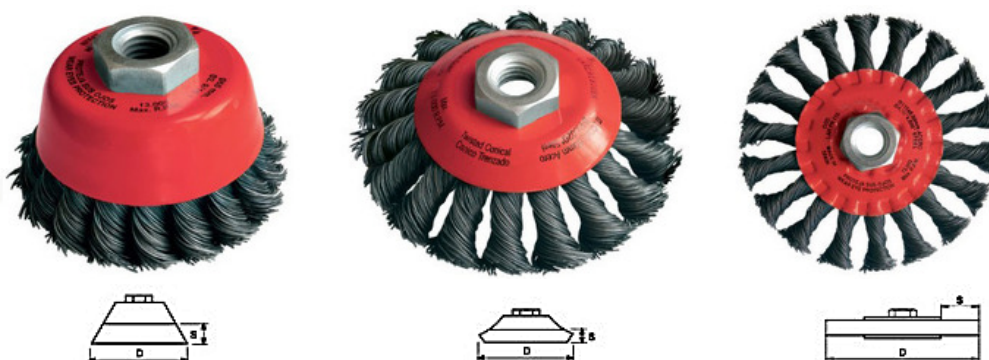

Modelo	Exterior (D)	Saliente (S)	Eixo de rosca (B)	R.P. M Recom.	R.P.M. Máx. de segurança	Unid. caixa
Copo	65 / 2.3/4"	22 / 7/8"	M-14 W-5/8 MR	11000	13000	12 (blister)
Cônico	100 / 4"	24 / 1"				
Plano	115 / 4.1/2"	25 / 1"				